

Product datasheet

Specifications

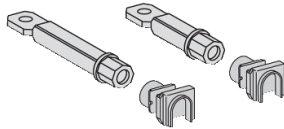

long rear connection, ComPact NS100/250, set of 2

29236

! Discontinued on: 1 Jan 2008

! End-of-service on: 30 June 2023

! Discontinued

Main

Range Of Product	INV100...250 NSF150...250 INS250 NR100...250 NS100...250
Product Or Component Type	Long rear connection
Accessory / Separate Part Category	Connection accessory
Range Compatibility	ComPact Compact NS100H ComPact Compact NS100N ComPact Compact NS160H ComPact Compact NS160N ComPact Compact NS250H ComPact Compact NS250N
Poles Description	2P 1P
Mounting Mode	Fixed
[In] Rated Current	250 A

Complementary

Location Of Connection	Rear
Localisation On Device	Top and bottom
Connection Pitch	35 mm
Shape	Long

Packing Units

Unit Type Of Package 1	PCE
Number Of Units In Package 1	1
Package 1 Height	2.3 cm
Package 1 Width	5.5 cm
Package 1 Length	11.7 cm
Package 1 Weight	282.0 g

Contractual warranty

Warranty	18 months
----------	-----------

Disclaimer: This documentation is not intended as a substitute for and is not to be used for determining suitability or reliability of these products for specific user applications

Sustainability

Green Premium™ label is Schneider Electric's commitment to delivering products with best-in-class environmental performance. Green Premium promises compliance with the latest regulations, transparency on environmental impacts, as well as circular and low-CO₂ products.

Guide to assessing product sustainability is a white paper that clarifies global eco-label standards and how to interpret environmental declarations.

[Learn more about Green Premium >](#)

[Guide to assess a product's sustainability >](#)



RoHS/REACH

Certifications & Standards

Eu Rohs Directive

Pro-active compliance (Product out of EU RoHS legal scope)

[EU RoHS Declaration](#)
