

# Product datasheet

Specifications



## ORANGE STROBE BEAC INTEGRAL LED 24VAC/DC

XVEL6B5

⚠ Discontinued on: 01-Nov-2020

⚠ Discontinued

### Main

Range Of Product	Harmony XVE Optimum
Product Or Component Type	Complete illuminated beacon
Beacon Or Indicator Bank Unit Type	1 base unit 1 illuminated unit 1 screw fixing cover 1 short fixing base
Signalling Type	Flashing
Component Name	XVE
Light Source	Integral flash discharge tube, orange
Bulb Type	Flash discharge tube
[Us] Rated Supply Voltage	24 V AC/DC

### Complementary

Mounting Diameter	70 mm
Flash Energy	1 J
Connections - Terminals	Screw clamp terminals, <= 1 x 1.5 mm² with cable end
Marking	CE
Short-Circuit Protection	0.63 A
[Ui] Rated Insulation Voltage	250 V conforming to IEC 60947-1
Nominal Voltage Limit	0.85...1.1 Un conforming to IEC 60947-5-1
Current Consumption	< 145 mA AC < 85 mA DC
[Uimp] Rated Impulse Withstand Voltage	4 kV conforming to IEC 60947-1
Flashing Frequency	1 Hz
Cad Overall Width	70 mm
Cad Overall Height	129 mm
Cad Overall Depth	70 mm
Terminals Description Iso N°1	(COM-1)PW (GND)GROUND
Net Weight	0.27 kg

### Environment

Disclaimer: This documentation is not intended as a substitute for and is not to be used for determining suitability or reliability of these products for specific user applications

Standards	EN/IEC 60947-5-1 EN/IEC 60947-1
Product Certifications	UL CSA CCC
Ambient Air Temperature For Storage	-40...70 °C
Ambient Air Temperature For Operation	-25...55 °C
Electrical Shock Protection Class	Class I aluminium tube mounting conforming to IEC 61140 Class I plastic tube mounting conforming to IEC 61140
Protective Treatment	TC
Ip Degree Of Protection	IP40 any position except vertical position conforming to IEC 60529 IP42 vertical position conforming to IEC 60529

## Packing Units

Unit Type Of Package 1	PCE
Number Of Units In Package 1	1
Package 1 Height	7 cm
Package 1 Width	7 cm
Package 1 Length	14 cm
Package 1 Weight	241 g

## Contractual warranty

Warranty	18 months
----------	-----------

## Sustainability



**Green Premium™ label** is Schneider Electric's commitment to delivering products with best-in-class environmental performance. Green Premium promises compliance with the latest regulations, transparency on environmental impacts, as well as circular and low-CO<sub>2</sub> products.

**Guide to assessing product sustainability** is a white paper that clarifies global eco-label standards and how to interpret environmental declarations.

[Learn more about Green Premium >](#)

[Guide to assess a product's sustainability >](#)

## Well-being performance

 Mercury Free	
 Rohs Exemption Information	<a href="#">Yes</a>
Eu Rohs Directive	Pro-active compliance (Product out of EU RoHS legal scope) <a href="#">EU RoHS Declaration</a>
China Rohs Regulation	<a href="#">China RoHS declaration</a>
Weee	The product must be disposed on European Union markets following specific waste collection and never end up in rubbish bins

Dimensions Drawings

Illuminated Beacon

Dimensions

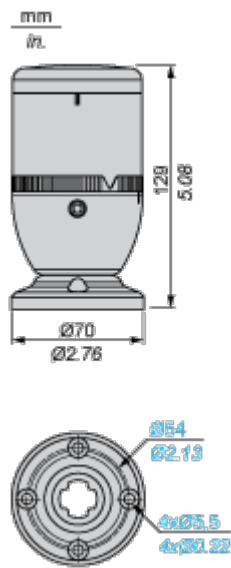

Mounting and Clearance

Illuminated Beacon

Panel Cut-out for Mounting Directly on Fixing Base

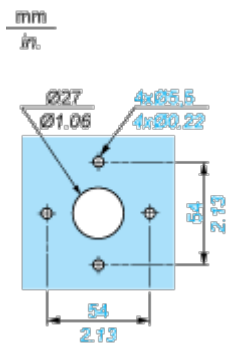

Connections and Schema

Illuminated Beacon

---

Wiring Diagram

