

# Product datasheet

Specifications



## beacon with buzzer + 1 illuminated unit - Ø 45 mm - 120 V AC

XVMG2RSHSB

⚠ Discontinued on: 19-Jan-2022

⚠ End-of-service on: 03-Jun-2022

⚠ Discontinued

### Main

Range Of Product	Harmony XVM
Product Or Component Type	Pre-assembled and pre-cabled beacon
Beacon Or Indicator Bank Unit Type	1 illuminated unit
Component Name	XVM
Light Source	Red super bright LED with BA 15d base steady signalling
Light Block Color	Red
[Us] Rated Supply Voltage	120 V AC
Indicator Bank Base Type	Base with integrated buzzer
Mounting Mode	Horizontal

### Complementary

Kit Composition	Plastic fixing plate Base unit Aluminium support tube Cover
Mounting Diameter	45 mm
Connections - Terminals	Flying leads,clamping capacity: 1 x 0.325 mm² (AWG 22)
Marking	CE
Mounting Support	Aluminium tube
Short-Circuit Protection	0.2 A
[Ui] Rated Insulation Voltage	250 V conforming to IEC 60947-1
Nominal Voltage Limit	0.85...1.1 Un conforming to IEC 60947-5-1
Current Consumption	18 mA on base unit 20 mA on flash discharge tube unit
[Uimp] Rated Impulse Withstand Voltage	4 kV conforming to IEC 60947-1
Flashing Frequency	0.8 Hz
Fundamental Frequency	4 kHz
Net Weight	0.355 kg

### Environment

Ip Degree Of Protection	IP54 horizontal position conforming to IEC 60529
Product Certifications	CCC

Disclaimer: This documentation is not intended as a substitute for and is not to be used for determining suitability or reliability of these products for specific user applications

Standards	EN/IEC 60947-1 EN/IEC 60947-5-1
Ambient Air Temperature For Storage	-25...70 °C
Ambient Air Temperature For Operation	-10...50 °C
Overvoltage Category	Class I conforming to IEC 60947-1 Class I conforming to IEC 60947-5-1 Class I conforming to IEC 61140
Protective Treatment	TC
Noise Level	0...80 dB at 1 m

## Packing Units

Unit Type Of Package 1	PCE
Number Of Units In Package 1	1
Package 1 Height	7.8 cm
Package 1 Width	8.5 cm
Package 1 Length	50.4 cm
Package 1 Weight	365 g

## Contractual warranty

Warranty	18 months
----------	-----------

# Sustainability



**Green Premium™ label** is Schneider Electric’s commitment to delivering products with best-in-class environmental performance. Green Premium promises compliance with the latest regulations, transparency on environmental impacts, as well as circular and low-CO<sub>2</sub> products.

**Guide to assessing product sustainability** is a white paper that clarifies global eco-label standards and how to interpret environmental declarations.

[Learn more about Green Premium >](#)

[Guide to assess a product’s sustainability >](#)

## Well-being performance

 Mercury Free	
 Rohs Exemption Information	<a href="#">Yes</a>
Reach Regulation	<a href="#">REACH Declaration</a>
Eu Rohs Directive	Compliant with Exemptions
China Rohs Regulation	<a href="#">China RoHS declaration</a>
Weee	The product must be disposed on European Union markets following specific waste collection and never end up in rubbish bins

Dimensions Drawings

Pre-Assembled and Pre-Cabled Tower Light with Fixing Base for Mounting on Horizontal Support (Support Tube + Plastic Fixing Plate)

Dimensions

Below drawing shows a tower light with 3 illuminated stages. Select the number of stages according to the product characteristics in order to get **b1** dimension.

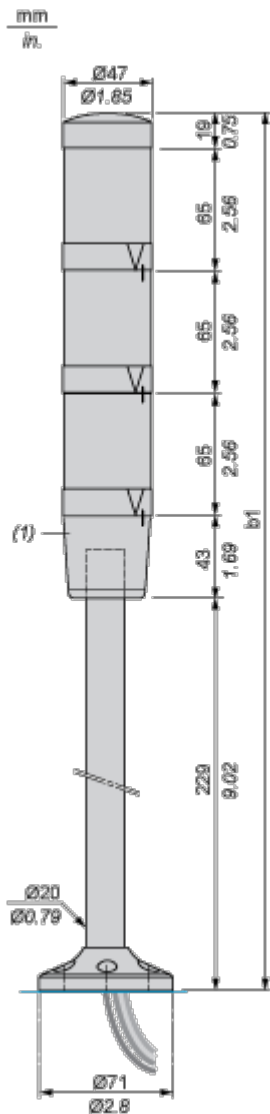

(1) Base unit with or without buzzer.

Number of illuminated units	b1 in mm	b1 in in.
1 unit	356	14.02
2 units	421	16.57
3 units	486	19.13
4 units	551	21.69

Connections and Schema

Pre-Assembled and Pre-Cabled Tower Light

---

Wire Colors

- 4th illuminated unit: yellow wire
- 3rd illuminated unit: green wire
- 2nd illuminated unit: white wire
- 1st illuminated unit: blue wire
- Common: black wire
- Buzzer (if integrated in base unit): grey wire

Technical Description

Base Unit with Integral Buzzer

---

Adjustment of Audible Signal

View from above:

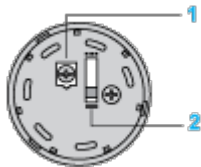

- (1) Volume adjustment potentiometer: 0 to 85 dB. Use either a cross headed or flat tipped screwdriver.
- (2) 2-position selector for type of audible signal: continuous tone or intermittent tone