

# Product data sheet

Specifications

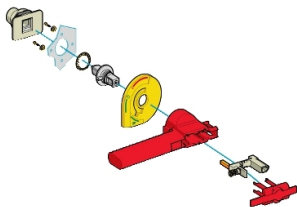

## rotary handle right side GS1 - 630...1250 A - red handle

GS1AH260

! Discontinued

### Main

Range Of Product	TeSys GS
Device Short Name	GS1 handle
Product Or Component Type	Handle
Product Compatibility	Switch disconnecter 32 A
Type Of Operating Handle	External
Mounting Location	Right
Handle Colour	Red

### Complementary

Handle Front Plate Colour	Yellow
Rotary Handle Padlocking	With
Net Weight	13227.75 lb(US) (6000 kg)

### Environment

Ip Degree Of Protection	IP65
-------------------------	------

### Ordering and shipping details

Category	18402-WORLD SERVICE PARTS(CONTROL ACCESS)
Discount Schedule	CP10
Gtin	3389110561654
Returnability	No
Country Of Origin	FR

### Contractual warranty

Warranty	18 months
----------	-----------

Price is "List Price" and may be subject to a trade discount – check with your local distributor or retailer for actual price.

## Sustainability

**Green Premium™ label** is Schneider Electric's commitment to delivering products with best-in-class environmental performance. Green Premium promises compliance with the latest regulations, transparency on environmental impacts, as well as circular and low-CO<sub>2</sub> products.

**Guide to assessing product sustainability** is a white paper that clarifies global eco-label standards and how to interpret environmental declarations.

[Learn more about Green Premium >](#)

[Guide to assess a product's sustainability >](#)

### California Proposition 65

WARNING: This product can expose you to chemicals including: Antimony oxide & Antimony trioxide, which is known to the State of California to cause cancer. Bisphenol A (BPA), which is known to the State of California to cause birth defects or other reproductive harm. For more information go to [www.p65warnings.ca.gov](http://www.p65warnings.ca.gov)

---