

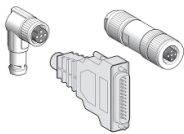

Product data sheet

Specifications



female Molex connector - 12-way - for CN2 - set of 5

VW3M8213

 **Discontinued on:** Oct 9, 2023

Product availability: Non-Stock - Not normally stocked in distribution facility

 **Discontinued**

Main

Range Of Product	Lexium
Accessory / Separate Part Category	Connection accessory
Product Or Component Type	Connector
Connector Type	12-way female Molex
Range Compatibility	Lexium 05
Product Compatibility	LXM05
Accessory / Separate Part Destination	Servo drive

Complementary

Quantity Per Set	Set of 5
------------------	----------

Ordering and shipping details

Category	US1PC5118305
Discount Schedule	PC51
Gtin	3389119207799
Returnability	No
Country Of Origin	CZ

Packing Units

Unit Type Of Package 1	PCE
Number Of Units In Package 1	1
Package 1 Height	0.59 in (1.5 cm)
Package 1 Width	5.91 in (15.0 cm)
Package 1 Length	3.94 in (10.0 cm)
Package 1 Weight	0.67 oz (19.0 g)
Unit Type Of Package 2	S01
Number Of Units In Package 2	50
Package 2 Height	5.91 in (15.0 cm)
Package 2 Width	5.91 in (15.0 cm)
Package 2 Length	15.75 in (40.0 cm)
Package 2 Weight	2.59 lb(US) (1.175 kg)

Price is "List Price" and may be subject to a trade discount – check with your local distributor or retailer for actual price.

Disclaimer: This documentation is not intended as a substitute for and is not to be used for determining suitability or reliability of these products for specific user applications

Contractual warranty

Warranty	18 months
----------	-----------

Sustainability

Green Premium™ label is Schneider Electric's commitment to delivering products with best-in-class environmental performance. Green Premium promises compliance with the latest regulations, transparency on environmental impacts, as well as circular and low-CO₂ products.

Guide to assessing product sustainability is a white paper that clarifies global eco-label standards and how to interpret environmental declarations.

[Learn more about Green Premium >](#)

[Guide to assess a product's sustainability >](#)

Well-being performance

✓	Reach Free Of Svhc	
✓	Toxic Heavy Metal Free	
✓	Mercury Free	
✓	Rohs Exemption Information	Yes
✓	Pvc Free	
Reach Regulation	REACH Declaration	
Eu Rohs Directive	Pro-active compliance (Product out of EU RoHS legal scope) EU RoHS Declaration	
China Rohs Regulation	China RoHS declaration	
California Proposition 65	WARNING: This product can expose you to chemicals including: Lead and lead compounds, which is known to the State of California to cause cancer and birth defects or other reproductive harm. For more information go to www.P65Warnings.ca.gov	