

Product data sheet

Specifications

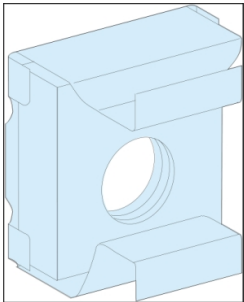

20 HEXA.SPACER M6 CAPTIVE NUTS

03194

⚠ Discontinued on: Jan 11, 2022

⚠ Discontinued

Main

Range	Prisma
Range Of Product	Prisma P Prisma G
Product Or Component Type	Captive nuts
Accessory / Separate Part Category	Installation accessory
Range Compatibility	Prisma Prisma P cubicle Prisma Prisma G mounting plate

Complementary

Mounting Mode	By clips
Mounting Support	Slotted mounting plate Functional uprights
Installation Description	Floor-standing enclosure - width 600 mm Wall-mounted enclosure - width 600 mm Floor-standing duct - width 300 mm Wall-mounted duct - width 300 mm Cubicle Cubicle duct
Iso Thread	M6
Quantity Per Set	Set of 20
Net Weight	0.08 kg

Packing Units

Unit Type Of Package 1	PCE
Number Of Units In Package 1	1

Disclaimer: This documentation is not intended as a substitute for and is not to be used for determining suitability or reliability of these products for specific user applications

Sustainability

Green Premium™ label is Schneider Electric’s commitment to delivering products with best-in-class environmental performance. Green Premium promises compliance with the latest regulations, transparency on environmental impacts, as well as circular and low-CO₂ products.

Guide to assessing product sustainability is a white paper that clarifies global eco-label standards and how to interpret environmental declarations.

[Learn more about Green Premium >](#)

[Guide to assess a product’s sustainability >](#)



Transparency RoHS/REACH

Well-being performance

✓ Reach Free Of Svhc

✓ Toxic Heavy Metal Free

✓ Mercury Free

✓ Rohs Exemption Information [Yes](#)

✓ Halogen Free Plastic Parts Product

Certifications & Standards

Eu Rohs Directive	Pro-active compliance (Product out of EU RoHS legal scope) EU RoHS Declaration
--------------------------	---

China Rohs Regulation	China RoHS declaration Pro-active China RoHS declaration (out of China RoHS legal scope)
------------------------------	---

Environmental Disclosure	Product Environmental Profile
---------------------------------	---