

# Product data sheet

Specifications

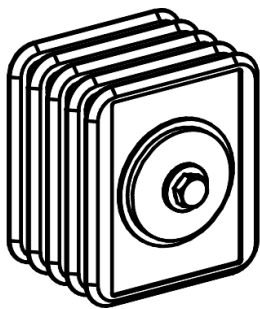

## CANALIS KR 3X1250AL JUNCTION BLOCK / YA

KRA1250YA3

### Main

Range	Canalis
Product Name	KR
Product Or Component Type	Electrical and mechanical jointing
Device Short Name	KRA
Range Compatibility	Canalis KR
Accessory / Separate Part Category	Connection accessory
Device Application	Jointing
Material	Aluminium
[Ie] Rated Operational Current	1250 A with aluminium
Polarity	3L

### Complementary

Housing Material	Mineral epoxy resin
Contacts Material	Tinned aluminium
[Ue] Rated Operational Voltage	1000 V
Mounting Location	Indoor Outdoor
Mounting Support	Self-tapping screw
Product Certifications	CE EAC ATEX
Standards	IEC 61439-6
Fixing Mode	By 1 bolt
Tightening Torque	84 N.m
Width	100 mm
Height	130 mm
Colour	Grey (RAL 7030)
Quantity Per Set	Set of 1

### Environment

Ip Degree Of Protection	IP68 conforming to IEC 60529
Ik Degree Of Protection	IK10 conforming to IEC 62262
Pollution Degree	3

Disclaimer: This documentation is not intended as a substitute for and is not to be used for determining suitability or reliability of these products for specific user applications

# Packing Units

Unit Type Of Package 1	PCE
Number Of Units In Package 1	1
Package 1 Height	13.0 cm
Package 1 Width	10.0 cm
Package 1 Length	30.0 cm
Package 1 Weight	9.45 kg

## Sustainability

**Green Premium™ label** is Schneider Electric's commitment to delivering products with best-in-class environmental performance. Green Premium promises compliance with the latest regulations, transparency on environmental impacts, as well as circular and low-CO<sub>2</sub> products.

**Guide to assessing product sustainability** is a white paper that clarifies global eco-label standards and how to interpret environmental declarations.

[Learn more about Green Premium >](#)

[Guide to assess a product's sustainability >](#)



Transparency   RoHS/REACH

## Well-being performance

✓ Reach Free Of Svhc

✓ Toxic Heavy Metal Free

✓ Mercury Free

✓ Rohs Exemption Information   [Yes](#)

✓ Halogen Free Product

## Certifications & Standards

Reach Regulation	<a href="#">REACH Declaration</a>
Eu Rohs Directive	Compliant <a href="#">EU RoHS Declaration</a>
China Rohs Regulation	<a href="#">China RoHS declaration</a> Pro-active China RoHS declaration (out of China RoHS legal scope)
Environmental Disclosure	<a href="#">Product Environmental Profile</a>
Weee	The product must be disposed on European Union markets following specific waste collection and never end up in rubbish bins
Circularity Profile	<a href="#">End of Life Information</a>