

# Product data sheet

Specifications

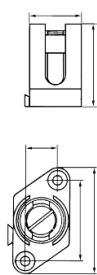

## Safety terminals section 1x100mm<sup>2</sup> . Supply : 10

NSYS95100

### Main

Accessory / Separate Part Category	Power distribution
Product Or Component Type	Safety terminal
Device Application	Multi-purpose
Range Compatibility	Spacial Thalassa
Device Composition	1 sigma terminal
Quantity Per Set	Set of 10
Nominal Cross Section	100 mm² 1

### Complementary

Mounting Location	On mounting accessories
Material	Polyamide 6 matt black for base Polypropylene orange for cover MS-58 brass for terminal Zinc-plated and dichromated steel for ring
Height	54 mm
Width	33 mm
Depth	58 mm
Diameter	33 mm

### Packing Units

Unit Type Of Package 1	PCE
Number Of Units In Package 1	1
Package 1 Height	4.000 cm
Package 1 Width	5.500 cm
Package 1 Length	5.500 cm
Package 1 Weight	98.000 g
Unit Type Of Package 2	BB1
Number Of Units In Package 2	10
Package 2 Height	5.000 cm
Package 2 Width	15.500 cm
Package 2 Length	18.500 cm
Package 2 Weight	1.035 kg

Disclaimer: This documentation is not intended as a substitute for and is not to be used for determining suitability or reliability of these products for specific user applications

Unit Type Of Package 3	S04
Number Of Units In Package 3	200
Package 3 Height	30.000 cm
Package 3 Width	40.000 cm
Package 3 Length	60.000 cm
Package 3 Weight	21.356 kg

## Contractual warranty

Warranty	18 months
----------	-----------

## Sustainability

**Green Premium™ label** is Schneider Electric's commitment to delivering products with best-in-class environmental performance. Green Premium promises compliance with the latest regulations, transparency on environmental impacts, as well as circular and low-CO<sub>2</sub> products.

**Guide to assessing product sustainability** is a white paper that clarifies global eco-label standards and how to interpret environmental declarations.

[Learn more about Green Premium >](#)

[Guide to assess a product's sustainability >](#)



Transparency   RoHS/REACH

## Well-being performance



Mercury Free



RoHS Exemption Information

Yes

## Certifications & Standards

Reach Regulation

[REACH Declaration](#)

Eu RoHS Directive

Pro-active compliance (Product out of EU RoHS legal scope)

China RoHS Regulation

[China RoHS declaration](#)

Product out of China RoHS scope. Substance declaration for your information

Environmental Disclosure

[Product Environmental Profile](#)

Circularity Profile

No need of specific recycling operations