

# Product data sheet

Specifications



## motion control stepper motor drive - SD218 - CAN open = 5A

SD218AU50C

### Main

Range Of Product	Lexium SD2
Product Or Component Type	Motion stepper drive
Device Short Name	SD218
Communication Interface	CANopen

### Complementary

Network Number Of Phases	Single phase
[Us] Rated Supply Voltage	24...48 V
Supply Voltage Type	DC
Supply Voltage Limits	12...48 V
Maximum Motor Phase Current	5 A
Current Consumption	<= 4 mA
Voltage State 0 Guaranteed	0...0.8 V for general purpose I/O defined as inputs
Voltage State 1 Guaranteed	2.2...24 V
Input Current	1.75 mA - high level for general purpose I/O defined as inputs
Output Current	600 mA - single channel, duty cycle = 0.8 for general purpose I/O defined as outputs 275 mA - four channels, continuous for general purpose I/O defined as outputs
Input Voltage	0...24 V for general purpose I/O defined as inputs
Residual Ripple	2 V at nominal voltage
Electrical Connection	1 connector wire crimp 4 pins for motor interface 1 connector wire crimp 2 pins for supply voltage 1 connector DB9 for fieldbus for CANopen interface 1 connector wire crimp 14 pins for multifunction interface
Transmission Rate	10, 20, 50, 100, 125, 250, 800, 1000 kbauds
Type Of Cooling	Convection
Width	76 mm
Height	54 mm
Depth	99 mm
Marking	CE
Net Weight	0.34 kg

### Environment

Disclaimer: This documentation is not intended as a substitute for and is not to be used for determining suitability or reliability of these products for specific user applications

Electromagnetic Compatibility	Electrostatic discharge conforming to IEC 61000-4-2 Immunity to radiated radio-electrical interference conforming to IEC 61000-4-3 Immunity to electrical transients conforming to IEC 61000-4-4 Voltage/current impulse conforming to IEC 61000-4-5 Immunity to voltage dips conforming to IEC 61000-4-11 Immunity to conducted RF disturbances conforming to IEC 61000-4-6
Standards	EN 55011 group 1 class A IEC 61000-3-2 EN 61000-3-3
Ambient Air Temperature For Operation	0...50 °C without derating with flange motor mounted on a steel plate 300 x 300 x 10 mm 50...65 °C with power derating of 2.2 % per °C with flange motor mounted on a steel plate 300 x 300 x 10 mm
Ambient Air Temperature For Storage	-25...70 °C
Relative Humidity	15...85 % without condensation
Operating Altitude	<= 1000 m without derating
Ip Degree Of Protection	IP20

## Packing Units

Unit Type Of Package 1	PCE
Number Of Units In Package 1	1
Package 1 Height	9.0 cm
Package 1 Width	13.4 cm
Package 1 Length	19.7 cm
Package 1 Weight	520.0 g
Unit Type Of Package 2	S03
Number Of Units In Package 2	8
Package 2 Height	30.0 cm
Package 2 Width	30.0 cm
Package 2 Length	40.0 cm
Package 2 Weight	4.873 kg

## Contractual warranty

Warranty	18 months
----------	-----------

## Sustainability

**Green Premium™ label** is Schneider Electric's commitment to delivering products with best-in-class environmental performance. Green Premium promises compliance with the latest regulations, transparency on environmental impacts, as well as circular and low-CO<sub>2</sub> products.

**Guide to assessing product sustainability** is a white paper that clarifies global eco-label standards and how to interpret environmental declarations.

[Learn more about Green Premium >](#)

[Guide to assess a product's sustainability >](#)

## Well-being performance

✔ Reach Free Of Svhc

✔ Mercury Free

✔ Pvc Free

Reach Regulation

[REACH Declaration](#)

Eu Rohs Directive

Not applicable, out of EU RoHS legal scope

China Rohs Regulation

[China RoHS declaration](#)

Weee

The product must be disposed on European Union markets following specific waste collection and never end up in rubbish bins

California Proposition 65

WARNING: This product can expose you to chemicals including: Lead and lead compounds, which is known to the State of California to cause cancer and birth defects or other reproductive harm. For more information go to [www.P65Warnings.ca.gov](http://www.P65Warnings.ca.gov)

Dimensions Drawings

Dimensions

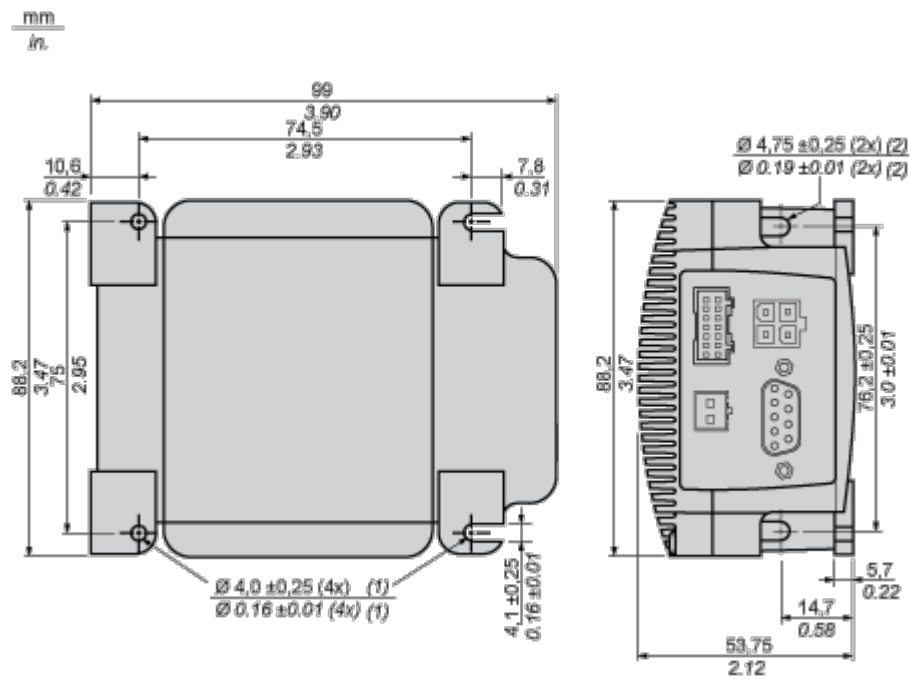

- (1) M3.5 screws for flat mount.
- (2) M4 screws for end mount.