

# Product data sheet

Specifications



power distribution kit, Modicon STB,  
standard, 24V DC

STBPDT3100K

## Main

Range Of Product	Modicon STB distributed I/O solution
Product Or Component Type	Standard power distribution kit

## Complementary

Kit Composition	STBXTS2130, spring type connectors STBPDT3100 module STBXBA2200 base STBXTS1130, screw type connectors
[Us] Rated Supply Voltage	24 V
Supply Circuit Type	DC
Power Supply Output Current	10 A at 45 °C (input/output circuit) 12 A at 30 °C (input/output circuit) 6 A at 70 °C (input/output circuit) 8 A at 60 °C (input/output circuit) 0...4 A at 30 °C (input circuit) 0...8 A at 30 °C (output circuit)
Voltage Range	19.2...30 V DC sensor/actuator bus
Hot Swapping Fallback	Hot swapping illegal
Protection Type	Built-in overcurrent protection, 10 A time-lag fuse for output circuit Built-in overcurrent protection, 5 A time-lag fuse for input circuit Reverse polarity for actuator bus
Permissible Current	30 A for 2 minutes grounding terminal
Voltage Detection Threshold	< 15 V +/-1 DC IN/OUT LED lit >= 15 V +/-1 DC IN/OUT LED non lit
Product Compatibility	Mounting base STBXBA2200
Marking	CE
Overvoltage Category	II
Status Led	1 LED (green) actuator bus power supply (OUT) 1 LED (green) sensor bus power supply (IN)
Depth	65.1 mm
Height	125 mm
Width	18.4 mm
Net Weight	0.13 kg

## Environment

Product Certifications	UL FM Class 1 Division 2 CSA
------------------------	------------------------------------

Disclaimer: This documentation is not intended as a substitute for and is not to be used for determining suitability or reliability of these products for specific user applications

Pollution Degree	2 conforming to IEC 60664-1
Operating Altitude	<= 2000 m
Ip Degree Of Protection	IP20 conforming to EN 61131-2 class 1
Ambient Air Temperature For Operation	0...60 °C (without) -25...70 °C (with derating factor)
Ambient Air Temperature For Storage	-40...85 °C
Relative Humidity	95 % at 60 °C without condensation
Vibration Resistance	+/-0.35 mm at 10...58 Hz 3 gn at 58...150 Hz on 35 x 7.5 mm symmetrical DIN rail 5 gn at 58...150 Hz on 35 x 15 mm symmetrical DIN rail
Shock Resistance	30 gn for 11 ms conforming to IEC 88 reference 2-27

## Packing Units

Unit Type Of Package 1	PCE
Number Of Units In Package 1	1
Package 1 Height	2.5 cm
Package 1 Width	8.5 cm
Package 1 Length	14.0 cm
Package 1 Weight	150.0 g
Unit Type Of Package 2	S02
Number Of Units In Package 2	24
Package 2 Height	15 cm
Package 2 Width	30 cm
Package 2 Length	40 cm
Package 2 Weight	4.026 kg
Unit Type Of Package 3	P06
Number Of Units In Package 3	384
Package 3 Height	75.0 cm
Package 3 Width	60.0 cm
Package 3 Length	80.0 cm
Package 3 Weight	75.52 kg

## Contractual warranty

Warranty	18 months
----------	-----------

## Sustainability



**Green Premium™** label is Schneider Electric's commitment to delivering products with best-in-class environmental performance. Green Premium promises compliance with the latest regulations, transparency on environmental impacts, as well as circular and low-CO<sub>2</sub> products.

**Guide to assessing product sustainability** is a white paper that clarifies global eco-label standards and how to interpret environmental declarations.

[Learn more about Green Premium >](#)

[Guide to assess a product's sustainability >](#)

## Well-being performance

 Mercury Free	
 Rohs Exemption Information	<a href="#">Yes</a>
Reach Regulation	<a href="#">REACH Declaration</a>
Eu Rohs Directive	Pro-active compliance (Product out of EU RoHS legal scope)
China Rohs Regulation	<a href="#">China RoHS declaration</a>
Weee	The product must be disposed on European Union markets following specific waste collection and never end up in rubbish bins
California Proposition 65	WARNING: This product can expose you to chemicals including: Lead and lead compounds, which is known to the State of California to cause cancer and birth defects or other reproductive harm. For more information go to <a href="http://www.P65Warnings.ca.gov">www.P65Warnings.ca.gov</a>

Dimensions Drawings

Dimensions

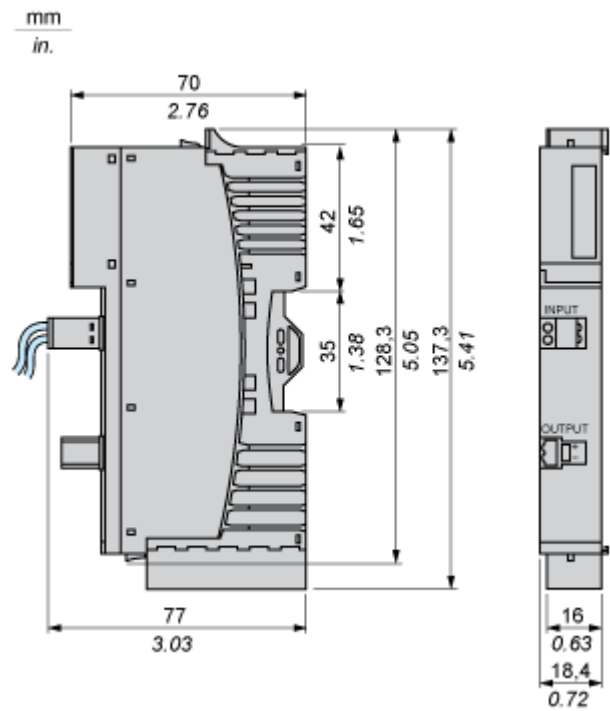

Connections and Schema

Wiring Diagrams

Examples

Single power supply

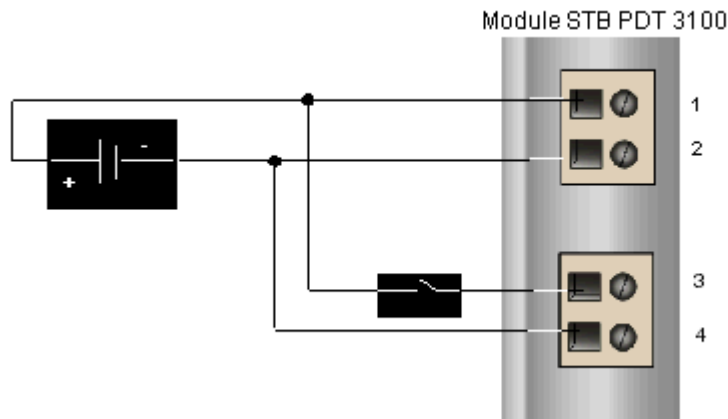

Separated power supplies

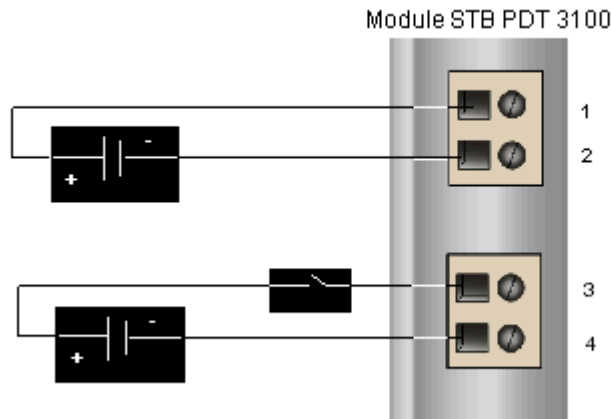

Pin	Top Connector	Bottom Connector
1	+24 VDC for the sensor bus	+24 VDC for the sensor bus
2	-24 VDC sensor power return	-24 VDC actuator power return

Performance Curves

Performance Curve

---

