

Product data sheet

Specifications



Illuminated push button, Harmony XB5, plastic, red flush, 22mm, universal LED, plain lens, 1NO + 1NC, 24V AC DC

XB5AW34B5

Important message: Viktig information: en förändring i utseendet kan observeras på produkten, men detta påverkar inte dess användning i termer av funktion och säkerhet. Detta gör den kompatibel med våra Universal LED-block

Main

| | |
|---------------------------------|---|
| Range Of Product | Harmony XB5 |
| Product Or Component Type | Illuminated push-button |
| Device Short Name | XB5 |
| Bezel Material | Dark grey plastic |
| Fixing Collar Material | Plastic |
| Head Type | Standard |
| Mounting Diameter | 22.5 mm |
| Sale Per Indivisible Quantity | 1 |
| Shape Of Signaling Unit Head | Round |
| Type Of Operator | spring return |
| Operator Profile | Red flush, unmarked |
| Operator Additional Information | With plain lens |
| Contacts Type And Composition | 1 NO + 1 NC |
| Contact Operation | Slow-break |
| Connections - Terminals | Screw clamp terminals, <= 2 x 1.5 mm² with cable end conforming to IEC 60947-1 Screw clamp terminals, 1 x 0.22...2 x 2.5 mm² without cable end conforming to IEC 60947-1 |
| Light Source | Universal LED |
| Bulb Base | Integral LED |
| [Us] Rated Supply Voltage | 24 V AC/DC 50/60 Hz |
| Cap/Operator Or Lens Colour | Red |

Complementary

| | |
|------------------------------------|---------------------------------------|
| Height | 42 mm |
| Width | 30 mm |
| Depth | 57 mm |
| Terminals Description Iso N°1 | (21-22)NC (13-14)NO |
| Net Weight | 0.056 kg |
| Resistance To High Pressure Washer | 7000000 Pa at 55 °C, distance : 0.1 m |

Disclaimer: This documentation is not intended as a substitute for and is not to be used for determining suitability or reliability of these products for specific user applications

| | |
|---|--|
| Contacts Usage | Standard contacts |
| Positive Opening | With conforming to IEC 60947-5-1 appendix K |
| Operating Travel | 1.5 mm (NC changing electrical state) 2.6 mm (NO changing electrical state) 4.3 mm (total travel) |
| Operating Force | 3.5 N NC changing electrical state 3.8 N |
| Mechanical Durability | 10000000 cycles |
| Tightening Torque | 0.8...1.2 N.m conforming to IEC 60947-1 |
| Shape Of Screw Head | Cross compatible with Philips no 1 screwdriver Cross compatible with pozidriv No 1 screwdriver Slotted compatible with flat Ø 4 mm screwdriver Slotted compatible with flat Ø 5.5 mm screwdriver |
| Contacts Material | Silver alloy (Ag/Ni) |
| Short-Circuit Protection | 10 A cartridge fuse type gG conforming to IEC 60947-5-1 |
| [Ith] Conventional Free Air Thermal Current | 10 A conforming to IEC 60947-5-1 |
| [Ui] Rated Insulation Voltage | 600 V (pollution degree 3) conforming to IEC 60947-1 |
| [Uimp] Rated Impulse Withstand Voltage | 6 kV conforming to IEC 60947-1 |
| [Ie] Rated Operational Current | 3 A at 240 V, AC-15, A600 conforming to IEC 60947-5-1 6 A at 120 V, AC-15, A600 conforming to IEC 60947-5-1 0.1 A at 600 V, DC-13, Q600 conforming to IEC 60947-5-1 0.27 A at 250 V, DC-13, Q600 conforming to IEC 60947-5-1 0.55 A at 125 V, DC-13, Q600 conforming to IEC 60947-5-1 1.2 A at 600 V, AC-15, A600 conforming to IEC 60947-5-1 |
| Electrical Durability | 1000000 cycles, AC-15, 2 A at 230 V, operating rate <3600 cyc/h, load factor: 0.5 conforming to IEC 60947-5-1 appendix C 1000000 cycles, AC-15, 3 A at 120 V, operating rate <3600 cyc/h, load factor: 0.5 conforming to IEC 60947-5-1 appendix C 1000000 cycles, AC-15, 4 A at 24 V, operating rate <3600 cyc/h, load factor: 0.5 conforming to IEC 60947-5-1 appendix C 1000000 cycles, DC-13, 0.2 A at 110 V, operating rate <3600 cyc/h, load factor: 0.5 conforming to IEC 60947-5-1 appendix C 1000000 cycles, DC-13, 0.5 A at 24 V, operating rate <3600 cyc/h, load factor: 0.5 conforming to IEC 60947-5-1 appendix C |
| Electrical Reliability | $\Lambda < 10\exp(-6)$ at 5 V, 1 mA in clean environment conforming to IEC 60947-5-4 $\Lambda < 10\exp(-8)$ at 17 V, 5 mA in clean environment conforming to IEC 60947-5-4 |
| Signalling Type | Steady |
| Supply Voltage Limits | 19.2...30 V DC 21.6...26.4 V AC |
| Current Consumption | 18 mA |
| Service Life | 100000 h at rated voltage and 25 °C |
| Surge Withstand | 1 kV conforming to IEC 61000-4-5 |
| Device Presentation | Complete product |

Environment

| | |
|---------------------------------------|---|
| Protective Treatment | TH |
| Ambient Air Temperature For Storage | -40...70 °C |
| Ambient Air Temperature For Operation | -40...70 °C |
| Overvoltage Category | Class II conforming to IEC 60536 |
| Ip Degree Of Protection | IP66 conforming to IEC 60529 IP69 IP69K IP67 |

| | |
|---------------------------------------|--|
| Nema Degree Of Protection | NEMA 13 NEMA 4X |
| Ik Degree Of Protection | IK05 conforming to IEC 50102 |
| Standards | UL 508 IEC 60947-5-1 IEC 60947-5-4 IEC 60947-1 CSA C22.2 No 14 JIS C8201-5-1 JIS C8201-1 |
| Product Certifications | LROS (Lloyds register of shipping) UL listed CSA BV GL DNV |
| Vibration Resistance | 5 gn (f= 2...500 Hz) conforming to IEC 60068-2-6 |
| Shock Resistance | 30 gn (duration = 18 ms) for half sine wave acceleration conforming to IEC 60068-2-27 50 gn (duration = 11 ms) for half sine wave acceleration conforming to IEC 60068-2-27 |
| Resistance To Fast Transients | 2 kV conforming to IEC 61000-4-4 |
| Resistance To Electromagnetic Fields | 10 V/m conforming to IEC 61000-4-3 |
| Resistance To Electrostatic Discharge | 6 kV on contact (on metal parts) conforming to IEC 61000-4-2 8 kV in free air (in insulating parts) conforming to IEC 61000-4-2 |
| Electromagnetic Emission | Class B conforming to IEC 55011 |

Packing Units

| | |
|------------------------------|-----------|
| Unit Type Of Package 1 | PCE |
| Number Of Units In Package 1 | 1 |
| Package 1 Height | 3.500 cm |
| Package 1 Width | 5.000 cm |
| Package 1 Length | 9.000 cm |
| Package 1 Weight | 55.300 g |
| Unit Type Of Package 2 | S03 |
| Number Of Units In Package 2 | 100 |
| Package 2 Height | 30.000 cm |
| Package 2 Width | 30.000 cm |
| Package 2 Length | 40.000 cm |
| Package 2 Weight | 5.927 kg |
| Unit Type Of Package 3 | P06 |
| Number Of Units In Package 3 | 800 |
| Package 3 Height | 75.000 cm |
| Package 3 Width | 80.000 cm |
| Package 3 Length | 60.000 cm |
| Package 3 Weight | 55.418 kg |

Contractual warranty

| | |
|----------|-----------|
| Warranty | 18 months |
|----------|-----------|

Sustainability

Green Premium™ label is Schneider Electric's commitment to delivering products with best-in-class environmental performance. Green Premium promises compliance with the latest regulations, transparency on environmental impacts, as well as circular and low-CO₂ products.

Guide to assessing product sustainability is a white paper that clarifies global eco-label standards and how to interpret environmental declarations.

[Learn more about Green Premium >](#)

[Guide to assess a product's sustainability >](#)



RoHS/REACH

Well-being performance

✓ Mercury Free

✓ Rohs Exemption Information Yes

Certifications & Standards

| | |
|---------------------------|---|
| Reach Regulation | REACH Declaration |
| Eu Rohs Directive | Pro-active compliance (Product out of EU RoHS legal scope) |
| China Rohs Regulation | China RoHS declaration |
| Weee | The product must be disposed on European Union markets following specific waste collection and never end up in rubbish bins |
| California Proposition 65 | WARNING: This product can expose you to chemicals including: Lead and lead compounds, which is known to the State of California to cause cancer and birth defects or other reproductive harm. For more information go to www.P65Warnings.ca.gov |

Dimensions Drawings

Dimensions

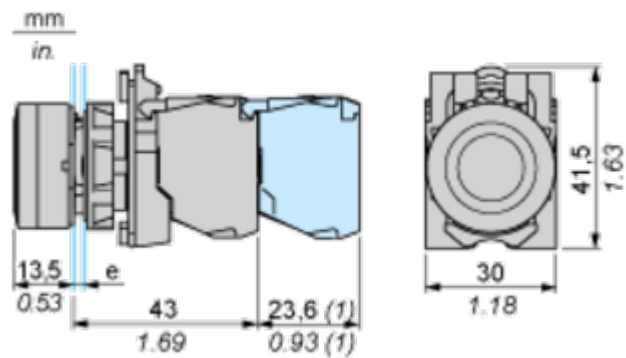

e: clamping thickness: 1 to 6 mm / 0.04 to 0.24 in.
(1) Additional row of contacts or double contact.

Mounting and Clearance

Panel Cut-out for Pushbuttons, Switches and Pilot Lights (Finished Holes, Ready for Installation)

Connection by Screw Clamp Terminals or Plug-in Connectors or on Printed Circuit Board

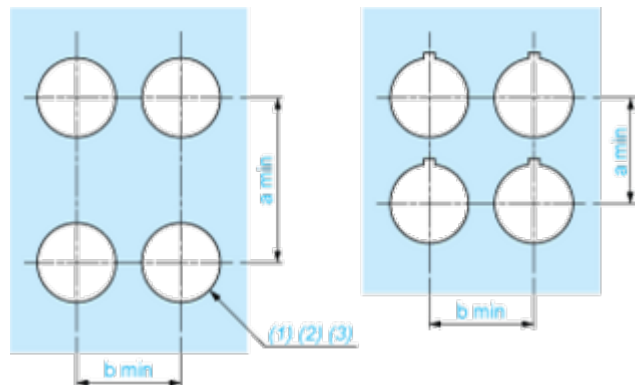

- (1) Diameter on finished panel or support
(2) For selector switches and Emergency stop buttons, use of an anti-rotation plate type ZB5AZ902 is recommended.
(3) Ø22.5 mm recommended ($\text{Ø}22.3 \begin{smallmatrix} +0.4 \\ 0 \end{smallmatrix}$) / Ø0.89 in. recommended ($\text{Ø}0.88 \text{ in. } \begin{smallmatrix} +0.016 \\ 0 \end{smallmatrix}$)

| Connections | a in mm | a in in. | b in mm | b in in. |
|---|---------|----------|---------|----------|
| By screw clamp terminals or plug-in connector | 40 | 1.57 | 30 | 1.18 |
| By Faston connectors | 45 | 1.77 | 32 | 1.26 |
| On printed circuit board | 30 | 1.18 | 30 | 1.18 |

Detail of Lug Recess

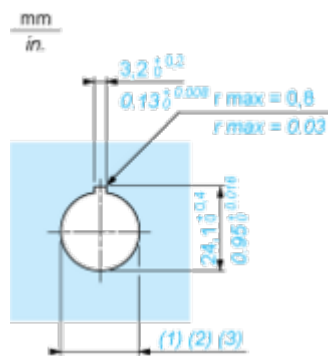

- (1) Diameter on finished panel or support
(2) For selector switches and Emergency stop buttons, use of an anti-rotation plate type ZB5AZ902 is recommended.
(3) Ø22.5 mm recommended ($\text{Ø}22.3 \begin{smallmatrix} +0.4 \\ 0 \end{smallmatrix}$) / Ø0.89 in. recommended ($\text{Ø}0.88 \text{ in. } \begin{smallmatrix} +0.016 \\ 0 \end{smallmatrix}$)