

# Product data sheet

Specifications



## Inductive proximity sensors XS, inductive sensor XS8 40x40x70, PBT, Sn40 mm, 12...48 VDC, M12

XS8C2A4NCM12

### Main

Range Of Product	Telemecanique Inductive proximity sensors XS
Series Name	General purpose
Sensor Type	Inductive proximity sensor
Device Application	Mobile equipment
Sensor Name	XS8
Sensor Design	Form 40 x 40 x 70
Size	70 mm
Body Type	Fixed
Detector Flush Mounting Acceptance	Non flush mountable
Material	Plastic
Enclosure Material	PBT
Type Of Output Signal	Discrete
Wiring Technique	3-wire
[Sn] Nominal Sensing Distance	40 mm
Discrete Output Function	1 NO + 1 NC
Output Circuit Type	DC
Discrete Output Type	NPN
Electrical Connection	Male connector M12, 4 pins
[Us] Rated Supply Voltage	12...48 V DC with reverse polarity protection
Switching Capacity In Ma	<= 200 mA with overload and short-circuit protection
Ip Degree Of Protection	IP67 conforming to IEC 60529 IP65 conforming to IEC 60529 IP69K conforming to DIN 40050

### Complementary

Detection Face	5 positions turret head
Front Material	PBT
Operating Zone	0...32 mm
Differential Travel	3...15% of Sr
Repeat Accuracy	<= 3% of Sr
Status Led	Supply on: 1 LED (green) Output state: 1 LED (yellow)

Disclaimer: This documentation is not intended as a substitute for and is not to be used for determining suitability or reliability of these products for specific user applications

Supply Voltage Limits	10...58 V DC
Switching Frequency	<= 500 Hz
Maximum Voltage Drop	<2 V (closed)
Current Consumption	0...15 mA no-load
Maximum Delay First Up	7.5 ms
Maximum Delay Response	1.4 ms
Maximum Delay Recovery	2.5 ms
Marking	CE
Height	40 mm
Length	40 mm
Width	70 mm
Net Weight	0.149 kg

## Environment

Product Certifications	CSA UL CCC E2
Ambient Air Temperature For Operation	-25...70 °C
Ambient Air Temperature For Storage	-40...85 °C
Vibration Resistance	25 gn amplitude = +/- 2 mm (f = 10...55 Hz) conforming to IEC 60068-2-6
Shock Resistance	50 gn for 11 ms conforming to IEC 60068-2-27

## Packing Units

Unit Type Of Package 1	PCE
Number Of Units In Package 1	1
Package 1 Height	4.600 cm
Package 1 Width	4.200 cm
Package 1 Length	8.700 cm
Package 1 Weight	156.000 g
Unit Type Of Package 2	S01
Number Of Units In Package 2	24
Package 2 Height	15.000 cm
Package 2 Width	15.000 cm
Package 2 Length	40.000 cm
Package 2 Weight	4.114 kg

## Contractual warranty

Warranty	18 months
----------	-----------

# Sustainability

**Green Premium™ label** is Schneider Electric’s commitment to delivering products with best-in-class environmental performance. Green Premium promises compliance with the latest regulations, transparency on environmental impacts, as well as circular and low-CO<sub>2</sub> products.

**Guide to assessing product sustainability** is a white paper that clarifies global eco-label standards and how to interpret environmental declarations.

[Learn more about Green Premium >](#)

[Guide to assess a product’s sustainability >](#)

Reach Regulation	<a href="#">REACH Declaration</a>
Eu Rohs Directive	Not applicable, out of EU RoHS legal scope
Circularity Profile	No need of specific recycling operations
California Proposition 65	WARNING: This product can expose you to chemicals including: Diisononyl phthalate (DINP), which is known to the State of California to cause cancer, and Diisodecyl phthalate (DIDP), which is known to the State of California to cause birth defects or other reproductive harm. For more information go to <a href="http://www.P65Warnings.ca.gov">www.P65Warnings.ca.gov</a>

Dimensions Drawings

Dimensions

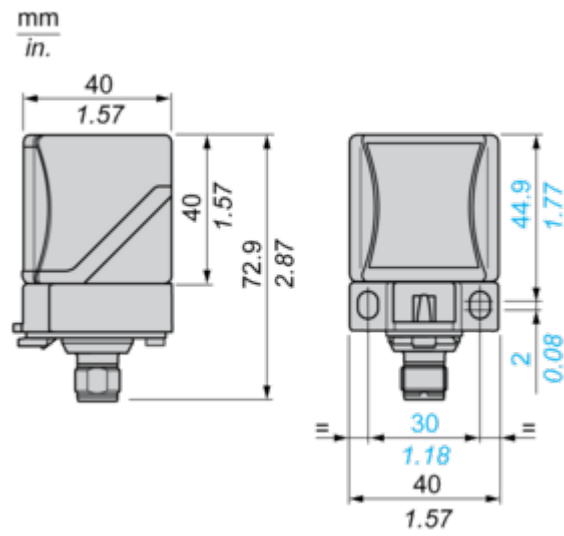

Mounting and Clearance

Mounting

---

Head Positions

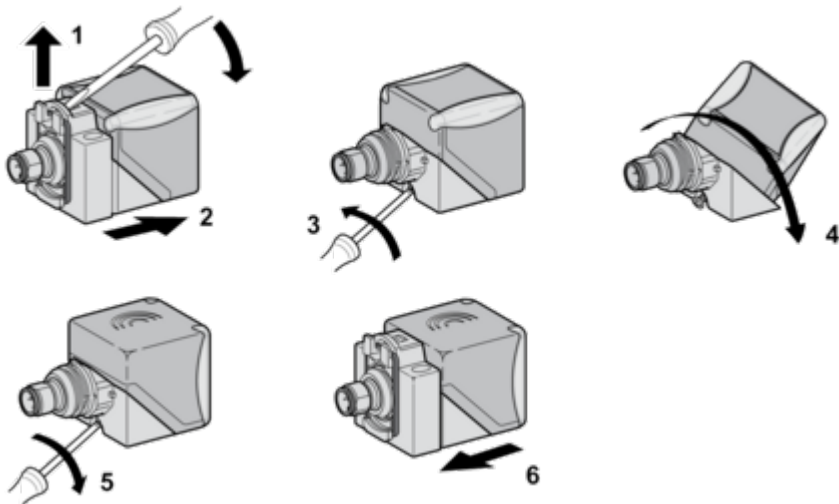

Setting-up Precautions

---

Minimum Mounting Distances (mm)

Side by Side

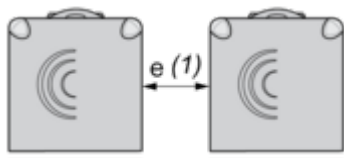

$e (1) \geq 160$

Face to Face

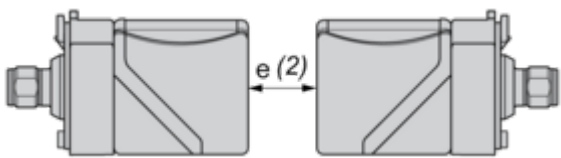

$e (2) \geq 320$

Facing a Metal Object

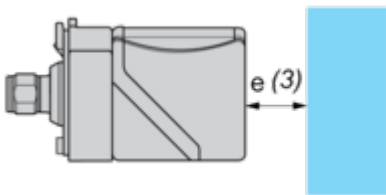

$e (3) \geq 120$

Connections and Schema

Wiring Schemes

4-Wire DC

