

# Product data sheet

Specifications



Pre assembled and pre cabled indicator bank, Harmony XVM, beacon, without buzzer + 2 illuminated units, Ø 45 mm, 230 V AC

XVMM2RGHSB

❗ Discontinued

❗ Discontinued on: Oct 20, 2020

## Main

Range Of Product	Harmony XVM
Product Or Component Type	Pre-assembled and pre-cabled indicator bank
Beacon Or Indicator Bank Unit Type	2 illuminated units
Component Name	XVM
Light Source	Green super bright LED with BA 15d base steady signalling Red super bright LED with BA 15d base steady signalling
Light Block Color	Red/green
[Us] Rated Supply Voltage	230 V AC
Indicator Bank Base Type	Base without buzzer
Mounting Mode	Horizontal

## Complementary

Kit Composition	Aluminium support tube Base unit Cover Plastic fixing plate
Mounting Diameter	45 mm
Connections - Terminals	Flying leads, clamping capacity: 1 x 0.325 mm <sup>2</sup> (AWG 22)
Marking	CE
Mounting Support	Aluminium tube
Short-Circuit Protection	0.2 A
[Ui] Rated Insulation Voltage	250 V conforming to IEC 60947-1
Nominal Voltage Limit	0.85...1.1 Un conforming to IEC 60947-5-1
Current Consumption	15 mA on steady LED unit
[Uimp] Rated Impulse Withstand Voltage	4 kV conforming to IEC 60947-1

## Environment

Ip Degree Of Protection	IP54 horizontal position conforming to IEC 60529
Product Certifications	CCC
Standards	EN/IEC 60947-5-1 EN/IEC 60947-1

Disclaimer: This documentation is not intended as a substitute for and is not to be used for determining suitability or reliability of these products for specific user applications

Ambient Air Temperature For Storage	-25...70 °C
Ambient Air Temperature For Operation	-10...50 °C
Overvoltage Category	Class I conforming to IEC 60947-1 Class I conforming to IEC 60947-5-1 Class I conforming to IEC 61140
Protective Treatment	TC

## Packing Units

Unit Type Of Package 1	PCE
Number Of Units In Package 1	1
Package 1 Height	7.8 cm
Package 1 Width	8.5 cm
Package 1 Length	50.4 cm
Package 1 Weight	425 g

## Contractual warranty

Warranty	18 months
----------	-----------

## Dimensions Drawings

### Pre-Assembled and Pre-Cabled Tower Light with Fixing Base for Mounting on Horizontal Support (Support Tube + Plastic Fixing Plate)

## Dimensions

Below drawing shows a tower light with 3 illuminated stages. Select the number of stages according to the product characteristics in order to get **b1** dimension.

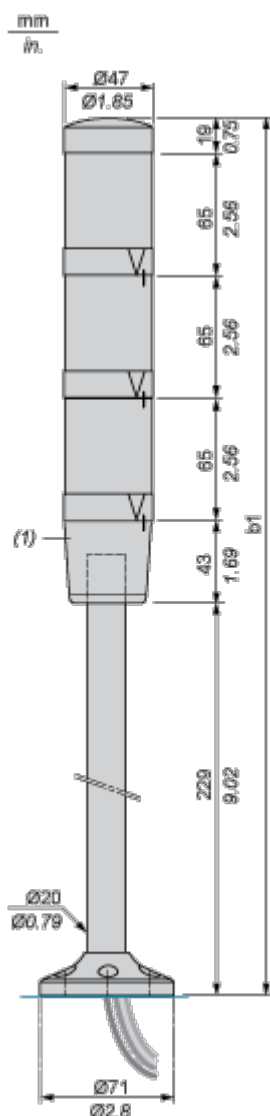

(1) Base unit with or without buzzer.

Number of illuminated units	b1 in mm	b1 in in.
1 unit	356	14.02
2 units	421	16.57
3 units	486	19.13
4 units	551	21.69

Connections and Schema

Pre-Assembled and Pre-Cabled Tower Light

---

Wire Colors

- 4th illuminated unit: yellow wire
- 3rd illuminated unit: green wire
- 2nd illuminated unit: white wire
- 1st illuminated unit: blue wire
- Common: black wire
- Buzzer (if integrated in base unit): grey wire