

# Product data sheet

Specifications



Beacon, Harmony XVR, illuminated beacon without buzzer, red, 100mm, integral LED, 12...24V DC

XVR3B04

## Main

|                                    |   |
|------------------------------------|---|
| Range Of Product                   | Harmony XVR   |
| Product Or Component Type          | Beacon  |
| Device Short Name                  | XVR3  |
| Beacon Or Indicator Bank Unit Type | LED unit  |
| Mounting Diameter                  | 100 mm  |
| Light Source                       | LED, red  |
| Device Application                 | Forklift<br>Automated guided vehicle (AGV)<br>Bulldozer |

## Complementary

|                                |  |
|--------------------------------|--|
| Signalling Type                | Blinking<br>Rotating<br>Flashing   |
| Assembly Style                 | Ready assembled  |
| Material                       | PC (polycarbonate): lenses<br>PBT (polybutylene terephthalate) + PC (polycarbonate): body<br>EPDM (ethylene propylene diene monomer): base |
| [Us] Rated Supply Voltage      | 12...24 V DC   |
| [Ue] Rated Operational Voltage | 10...30 V DC   |
| Inrush Current                 | 3 A  |
| Power Consumption In W         | 2.8 W  |
| Marking                        | CE   |
| Installation Direction         | Upright indoor<br>Sideways indoor<br>Inverted indoor<br>Upright outdoor  |
| Electrical Insulation Class    | Class II   |
| Current Consumption            | 3000 mA  |
| Length                         | 100 mm   |
| Width                          | 100 mm   |
| Height                         | 139 mm   |
| Net Weight                     | 0.484 kg   |

## Environment

|                                       |             |
|---------------------------------------|-------------|
| Ambient Air Temperature For Operation | -20...50 °C |
|---------------------------------------|-------------|

Disclaimer: This documentation is not intended as a substitute for and is not to be used for determining suitability or reliability of these products for specific user applications

|                                     |  |
|-------------------------------------|--|
| Ambient Air Temperature For Storage | -35...70 °C  |
| Relative Humidity                   | 35...85 % without condensation                             |
| Vibration Resistance                | 4.6 gn (sideways)<br>4.6 gn (inverted)<br>7.1 gn (upright) |
| Ip Degree Of Protection             | IP65 (upright)<br>IP23 (sideways)<br>IP23 (inverted)       |

## Packing Units

|                              |          |
|------------------------------|----------|
| Unit Type Of Package 1       | PCE      |
| Number Of Units In Package 1 | 1        |
| Package 1 Height             | 13.5 cm  |
| Package 1 Width              | 13.85 cm |
| Package 1 Length             | 18.5 cm  |
| Package 1 Weight             | 640 g    |

# Sustainability



**Green Premium™ label** is Schneider Electric’s commitment to delivering products with best-in-class environmental performance. Green Premium promises compliance with the latest regulations, transparency on environmental impacts, as well as circular and low-CO<sub>2</sub> products.

**Guide to assessing product sustainability** is a white paper that clarifies global eco-label standards and how to interpret environmental declarations.

[Learn more about Green Premium >](#)

[Guide to assess a product’s sustainability >](#)

## Well-being performance

|   |   |                                     |
|---|---|-------------------------------------|
|  | Toxic Heavy Metal Free  |                                     |
|  | Mercury Free  |                                     |
|  | Rohs Exemption Information  | <a href="#">Yes</a>                 |
| <b>Reach Regulation</b>   | <a href="#">REACH Declaration</a>   |                                     |
| <b>Eu Rohs Directive</b>  | Compliant   | <a href="#">EU RoHS Declaration</a> |
| <b>China Rohs Regulation</b>  | <a href="#">China RoHS declaration</a>  |                                     |
| <b>Weee</b>   | The product must be disposed on European Union markets following specific waste collection and never end up in rubbish bins |                                     |

Dimensions Drawings

Dimensions

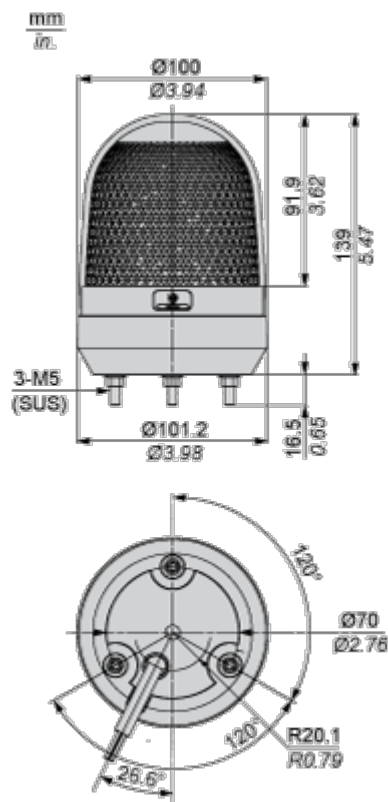

Mounting and Clearance

Panel Cut-out

Straight wiring

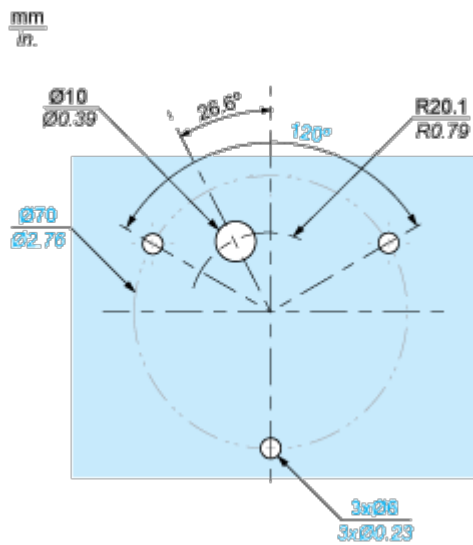

Side wiring

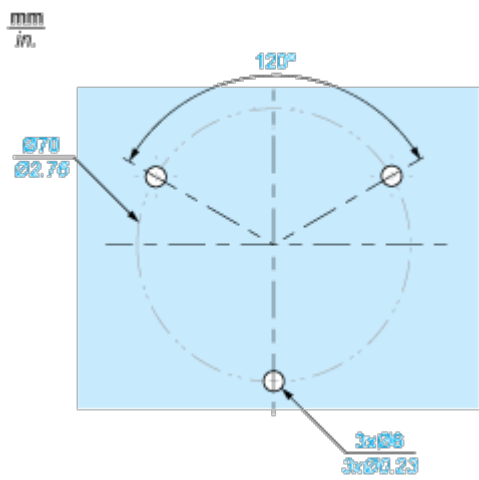

Connections and Schema

Wiring Diagram

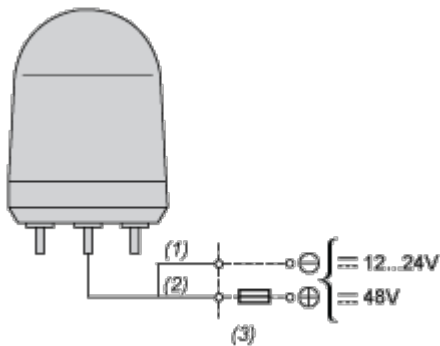

- (1) Black
- (2) White
- (3) Fuse(Rated Current>2A)