

Product data sheet

Specifications



Fixing plate for use on vertical support for modular tower lights, Harmony XVU, black, 60mm

XVUZ12

Main

Range Of Product	Harmony XVU
Product Or Component Type	Modular tower light
Accessory / Separate Part Type	Fixing plate
Accessory / Separate Part Category	Mounting and fixing accessory
Component Name	XVU
Mounting Diameter	60 mm

Complementary

Mounting Support	Wall mounted
Product Compatibility	XVUZ05 XVUZ800 XVUZ400 XVUZ02Q XVUZ02
Material	Aluminium V-0 conforming to UL 94
Housing Colour	Black
[Us] Rated Supply Voltage	24 V AC/DC 110...240 V AC
Length	8 mm
Net Weight	0.36 kg

Environment

Ambient Air Temperature For Storage	-40...70 °C
Ambient Air Temperature For Operation	-25...50 °C
Ip Degree Of Protection	IP65
Product Certifications	CSA UL CE

Packing Units

Unit Type Of Package 1	PCE
Number Of Units In Package 1	1
Package 1 Height	5.068 cm
Package 1 Width	6.844 cm
Package 1 Length	11.412 cm

Disclaimer: This documentation is not intended as a substitute for and is not to be used for determining suitability or reliability of these products for specific user applications

Package 1 Weight	491.0 g
Unit Type Of Package 2	CAR
Number Of Units In Package 2	10
Package 2 Height	15.6 cm
Package 2 Width	15.3 cm
Package 2 Length	39.8 cm
Package 2 Weight	5.651 kg

Sustainability

Green Premium™ label is Schneider Electric's commitment to delivering products with best-in-class environmental performance. Green Premium promises compliance with the latest regulations, transparency on environmental impacts, as well as circular and low-CO₂ products.

Guide to assessing product sustainability is a white paper that clarifies global eco-label standards and how to interpret environmental declarations.

[Learn more about Green Premium >](#)

[Guide to assess a product's sustainability >](#)



Transparency RoHS/REACH

Well-being performance

✓ Mercury Free

✓ Rohs Exemption Information [Yes](#)

Certifications & Standards

Reach Regulation	REACH Declaration
Eu Rohs Directive	Pro-active compliance (Product out of EU RoHS legal scope)
China Rohs Regulation	China RoHS declaration
Environmental Disclosure	Product Environmental Profile
Circularity Profile	End of Life Information
California Proposition 65	WARNING: This product can expose you to chemicals including: Lead and lead compounds, which is known to the State of California to cause cancer and birth defects or other reproductive harm. For more information go to www.P65Warnings.ca.gov

Dimensions Drawings

Dimensions

Rear View

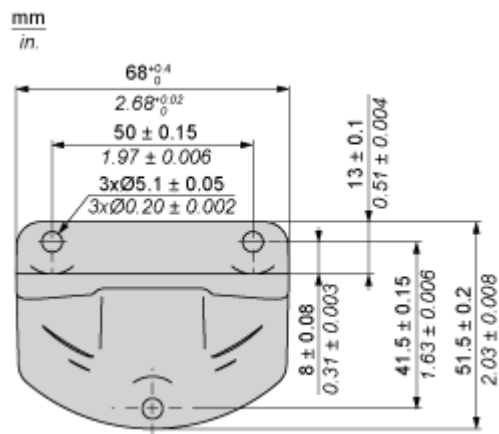

Side View

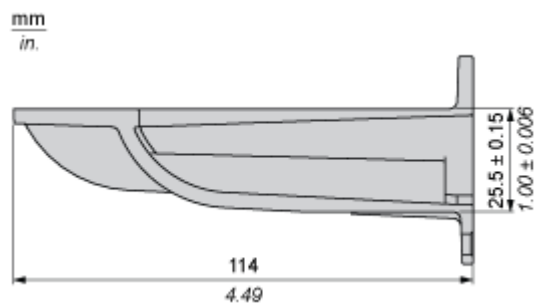

Mounting and Clearance

Vertical Support Panel Drillings

